

WEB PICTURE PREPARATION

Here is the recipe to prepare your POW for the Virtual Gallery web page:

Create the Folder

create a folder _____ in the TEMP folder on your computer

name it _____ *your_nameC1* (exactly like that!)

You must save all files to the **same** folder, or this will not work!

You must save all files with exactly these file names, or this will not work!
(except that you will change the number for each crit accordingly)

Prepare the Web Pic

open _____ you picture file in Photoshop

convert _____ the color space to sRGB from Adobe (1998)

hit _____ SAVE FOR WEB [CMD] [OPT] [SHFT] S

follow _____ the four steps below to optimize and resize, then

resize _____ the image to 384 pixels on the short side

save the file as _____ *your_nameC1W.jpg* (exactly like that!)

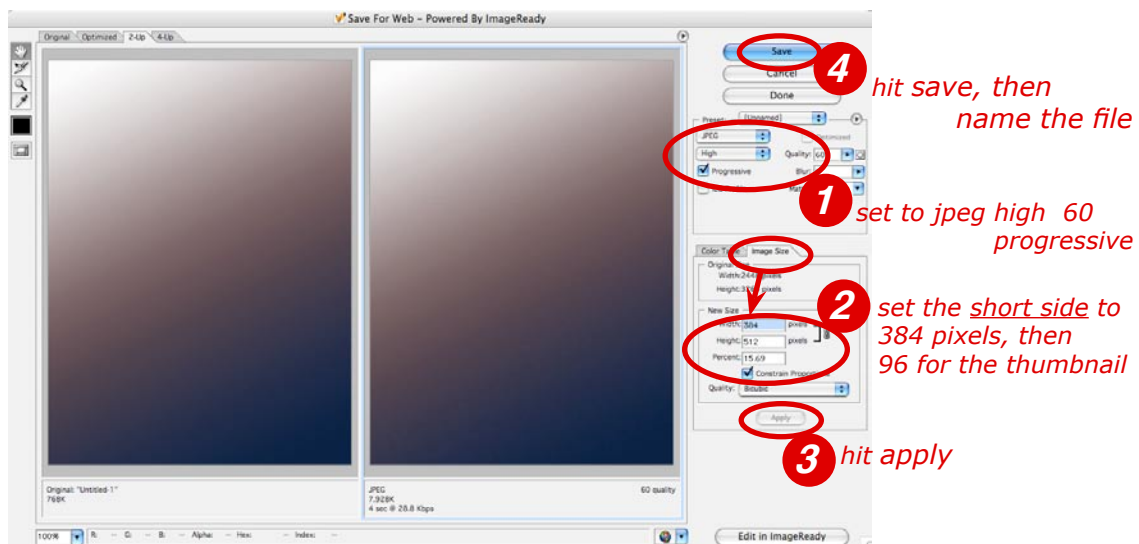

Prepare the Thumbnail

hit _____ SAVE FOR WEB again

resize _____ the image to 96 pixels on the short side

save the file as _____ *your_nameC1T.jpg* (exactly like that!)

close the file _____ but DON'T SAVE [CMD] W [CMD] D

For this to work properly, the Thumbnail Picture, the Web Picture, and the Web Page must all be in the same folder within the TEMP folder on your computer.

All file names must be in lowercase with an underscore character separating your first name from your last name. The letter C, W, and T at the end must be upper case.

You must use exactly the same name format for every crit.

WEB PAGE PREPARATION

Prepare the Web Page

open _____ the sample page from the BERK-EDU web site in Dreamweaver, or -
use the file *your_name.html* in the BERKwork folder (no C1)
save as _____ **immediately** into the same folder as your web pix
DO NOT _____ Update Links if asked
rename _____ the file *your_name.html* (no C1, exactly like that!)

Modify the Page

click on the picture _____ to make it active
adjust _____ the four items shown below, working from the bottom up

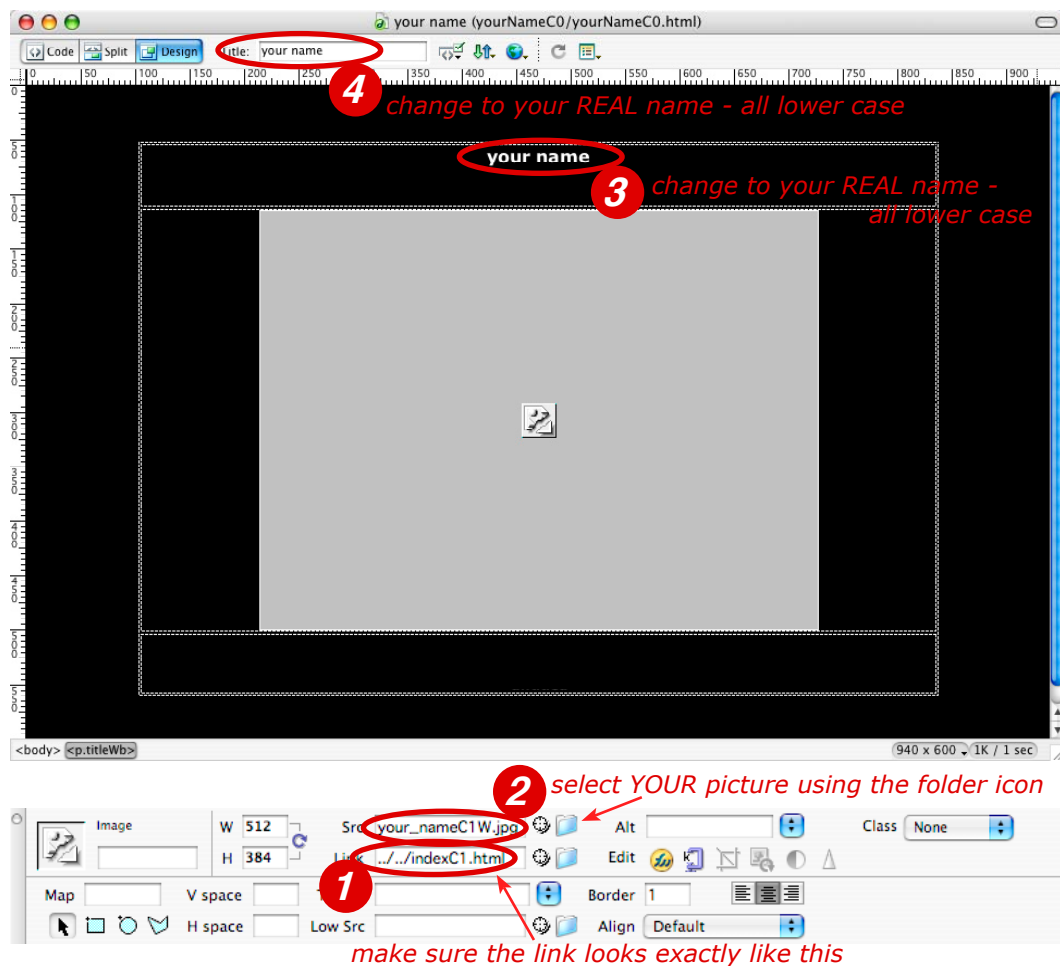

Hand in the Finished Files

make sure _____ both picture files and the web page file
have all been saved to your folder in the TEMP folder
transfer _____ your entire folder
to your class' critique folder within the ART FOLDER

The site cannot be completed until all files are received. If you are late, your pictures will not be published, you will not have completed the work for this crit, and your grade will drop.